

The information contained in this drawing is the sole property of CWS Coil Winding Specialist. Any reproduction in part or whole without written permission of CWS Coil Winding Specialist is prohibited.

REVISION HISTORY

REV	ECN	DESCRIPTION	BY	DATE	CHK	DATE
--		PRODUCTION RELEASE	KLC	7/19/08	RL	7/19/08

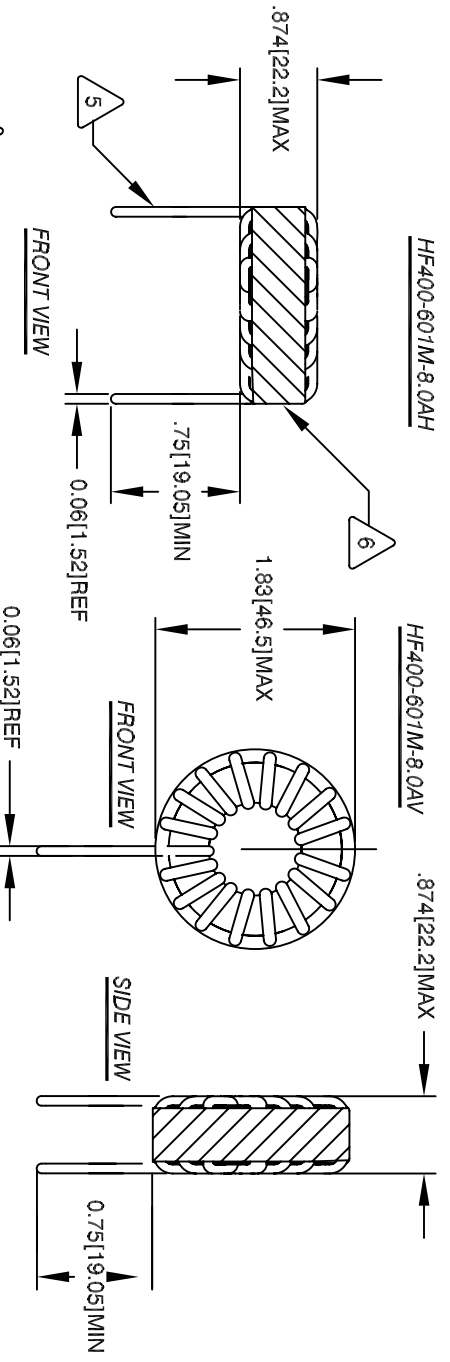
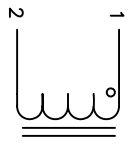

- 7 BUILD TO ROHS COMPLIANCE - LEAD FREE
- A PERMANENT MARKING METHOD
- MARK PART NUMBER AND REVISION USING
- WRAP INDUCTOR WITH GLASS OR MYLAR TAPE

- 6 TO THE CORE
- MUST REST FLAT ON PCB. LEADS MUST BE TANGENT
- FLUSH WITH THE COIL EDGE. AS SHOWN (I.E. COIL
- REMOVE INSULATION AND TIN LEADS 0.75 INCH MIN
- WIND COILS EVENLY SPACED AROUND THE CORE
- CONSTRUCTION:

- 4 HI-POT TEST FOR WINDING TO CORE ISOLATION = 500VDC MIN
- CURRENT RATING : 8 AMPS, 25 °C TEMP. RISE, NO AIR FLOW
- DCR = 45.0 MILLI-OHMS MAX.
- DC BIASED= 5.0 AMPS, INDUCTANCE = 420 UH
- DC BIASED= 8.0 AMPS, INDUCTANCE = 320 UH
- INDUCTANCE = 600 UH ±15% @ LOW DC BIAS, 1 KHZ, 250mv
- SPECIFICATIONS:

- 3 WIRE: UL RECOGNIZED 200°C RATED MAGNET WIRE
- CWS BYTE-MARK OR OTHER APPROVED PART
- CORE: COATED HIGH FLUX TOROIDAL CORE
- 1 RATING CLASS B (130°C MIN.) REQUIRED
- MATERIAL: UL RECOGNIZED 94V-0 FOR FLAMMABILITY

NOTES: TOROIDAL POWER CHOKE. ALL DIMENSIONS IN INCHES

BOTTOM VIEW

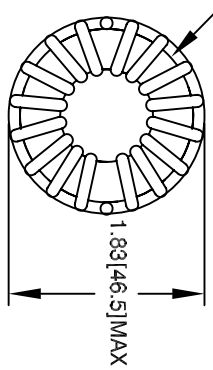

MOUNTING HOLES PATTERN (HORIZONTAL)

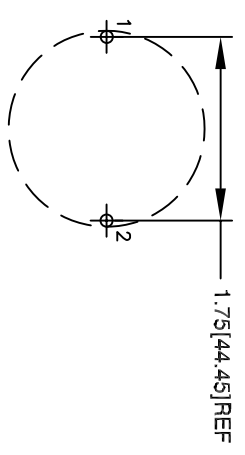

MOUNTING HOLES PATTERN (VERTICAL)

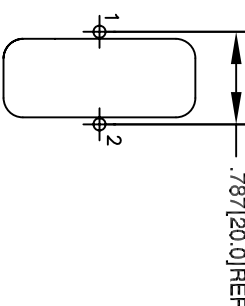

CODE IDENT	MFG. P/N	DESCRIPTION	ITEM NO.
PARTS LIST			
AUTOCAD SOLIDWORKS		CWS Coil Winding Specialist	
DRWN	DATE	ENGR	APPR
KLC	5/6/08	KLC	5/6/08
TITLE:		Toroidal Power Inductor	
SIZE		Dwg. No.	
B		HF-400-601M-8.0A	
SCALE		2=1	
DO NOT SCALE DRAWING			